

GENERAL NOTES

- CAVITY WALLS TO BE TIED TOGETHER WITH 2.5 WIRE TIES PER SQ METRE.
- CAVITY WALLS TO BE SEALED OFF ABOVE WALL PLATE AND BELOW D.P.C.
- RAIN-WATER TO DISCHARGE MIN. 3m FROM BUILDINGS AND BOUNDARIES.
- FLASHINGS TO BE PROVIDED TO PARAPETS AND CHIMNEYS.
- GLAZING TO DOORS AND WINDOWS IN EXCESS OF 1 SQ METRE OR LESS THAN 300mm ABOVE FINISHED FLOOR
- LEVEL TO BE SAFETY GLAZED IN ACCORDANCE WITH BUILDING REGULATION PART N.
- DAMP- PROOF MEMBRANE IS TO BE 150mm MIN. ABOVE FINISHED GROUND LEVEL.
- GABLE END WALLS TO BE SECURED AND ANCHORED WITH GALV. HOOP IRON STRAPS 1,2mm THICK BY 30mm WIDE AT 600 CENTRES EMBEDDED 600mm IN WALL, BENT OVER AND FIXED TO 3 RAFTERS.
- RAFTERS TO BE TIED DOWN TO WALLS WITH 1,2mm BY 30mm GALV. HOOP IRON STRAPS EMBEDDED 600mm IN WALL.
- ROOF TIMBERS TO BE 200MM MIN. FROM CHIMNEY FLUE
- PRE-CAST LINTOLS + 4 COURSES BRICKWORK WITH BRICKFORCE OVER ALL OPENINGS LESS THAN 3m WIDE.
- ALL STRUCTURAL TIMBER TO BE GRADE 4 S.A.P. AND WRAPPED IN D.P.M. WHEN BUILT IN WALLS.
- ALL NEW OR EXISTING DRAINAGE TO BE ENCASED IN CONCRETE UNDER NEW FLOOR SLABS.
- INTERNAL FOUNDATIONS = 700X230 STRIP CONCRETE
- NO PART OF ANY CONCRETE FOOTING TO ENCR OACH OVER ANY SITE BOUNDARY

FINISHES

- FLOORS**
 - QUARRY TILES IN ALL LIVING, BATHROOM AND SERVICE AREAS
 - CARPET IN BEDROOMS
 - QUARRY TILES TO ENCLOSED AND COVERED VERANDAH, SERVICE AND SERVANTS AREAS
 - CRUSHER RUN STONE CHIP TO YARD AREAS
- CEILINGS**
 - SKIMMED GYPSUM CEILING TO FIRST FLOOR AREAS WITH PROFILED GYPSUM CORNICE TO OWNERS CHOICE
 - SUSPENDED SKIMMED GYPSUM CEILING BELOW SLAB SOFFIT WITH PAINT FINISH AND PROFILED GYPSUM CORNICES (GROUND FLOOR AREAS)
- WALLS**
 - PLASTER AND PAINT FINISH TO SAMPLE APPROVAL BY ARCHITECT INTERNALLY AND EXTERNALLY
- PITCHED ROOFS**
 - "CHROMADEK" FACTORY APPLIED PAINT FINISH ON CORRUGATED GALVANISED SHEET METAL ON 50 x 75 SAP PURLINS ON TIMBER ROOF TRUSSES TO SPECIALIST DESIGN AND FABRICATION

M	TAKE OUT SHOWER WALL IN BATHROOM 2	11 SEPTEMBER 07
L	DOOR TO BED. 4 CHANGED; WALL THICKNESSES	28 JUNE 07
K	GENERAL CHANGES	18 JUNE 07
J	BATHROOM DETAILS	13 JUNE 07
I	DOOR AND WINDOW NUMBERS	30 MAY 07
H	GENERAL CHANGES	03 MAY 07
G	GENERAL CHANGES	25 APRIL 07
F	1st FLOOR CEILING DROPPED, BALCONY REMOVED	17 APRIL 07
E	GENERAL CHANGES	22 MARCH 07
D	HOUSE REDUCED IN SIZE	5 MARCH 07
C	MAIN HOUSE REDUCED IN LENGTH BY 250MM	12 FEB. 07
B	GENERAL AMMENDMENTS	8 FEB. 07
A	HOUSE DECREASED IN SIZE	30 JAN. 07
REV. No	REVISION	DATE

MICHAEL DALL
ARCHITECTS

27 MAINS AVENUE, KENILWORTH, CAPE TOWN. 7708
TEL. : (021) 797 8102 / 762 2383 FAX : (021) 797 7094
mjdall@iafrica.com

PROJECT TITLE
BISHOPSCOURT HOUSE

DRAWING TITLE
FIRST FLOOR PLAN

DRAWN	DATE	SCALE
SL	DECEMBER 2006	AS INDICATED
JOB NO.	DWG. NO.	REVISION
09 / 06	03	M

FIRST FLOOR PLAN
SCALE 1:100

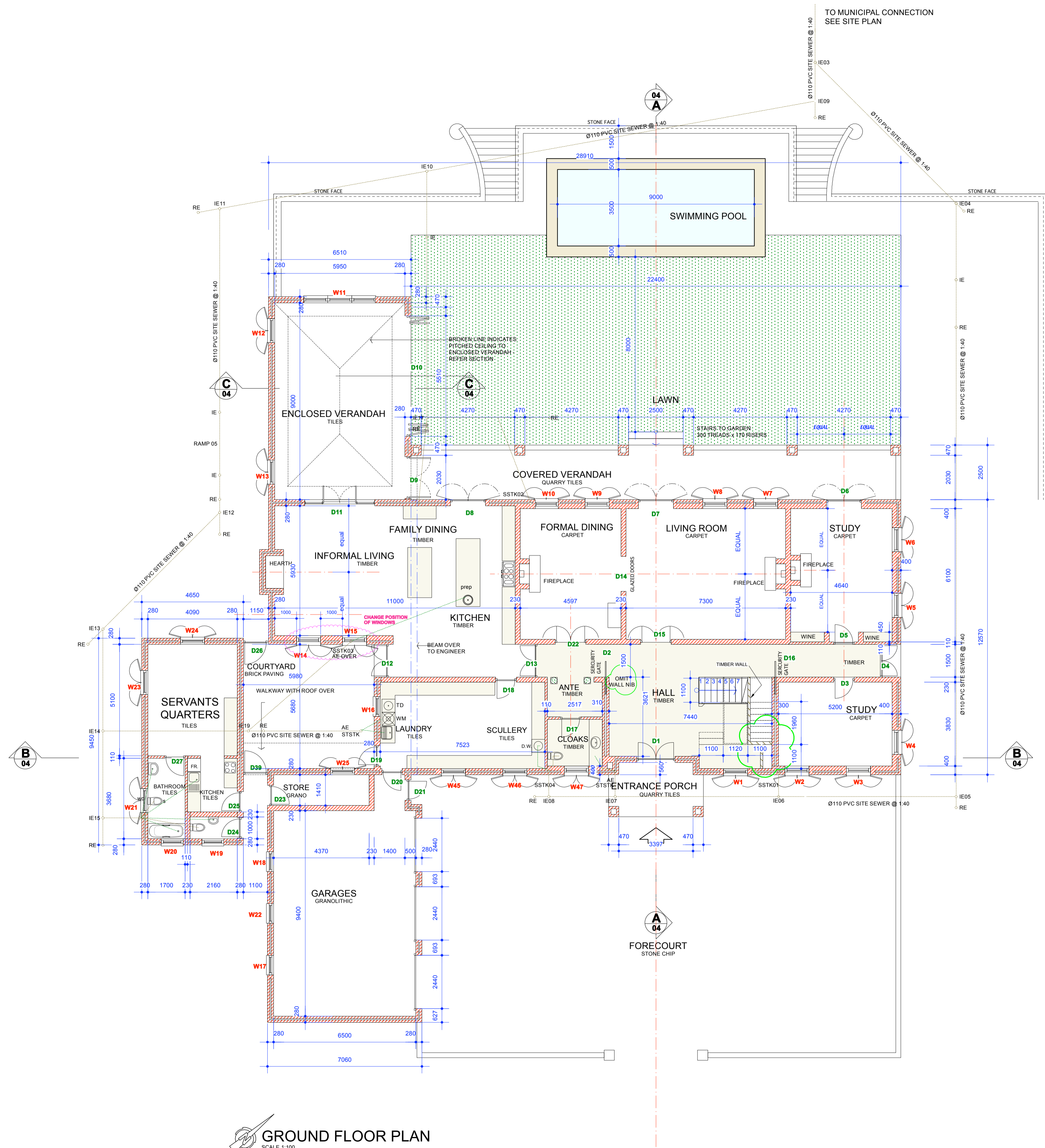

GENERAL NOTES

- CAVITY WALLS TO BE TIED TOGETHER WITH 2.5 WIRE TIES PER SQ METRE.
- CAVITY WALLS TO BE SEALED OFF ABOVE WALL PLATE AND BELOW D.P.C.
- RAIN-WATER TO DISCHARGE MIN. 3m FROM BUILDINGS AND BOUNDARIES.
- FLASHINGS TO BE PROVIDED TO PARAPETS AND CHIMNEYS.
- GLAZING TO DOORS AND WINDOWS IN EXCESS OF 1 SQ METRE OR LESS THAN 300mm ABOVE FINISHED FLOOR
- LEVEL TO BE SAFETY GLAZED IN ACCORDANCE WITH BUILDING REGULATION PART N.
- DAMP-PROOF MEMBRANE IS TO BE 150mm MIN. ABOVE FINISHED GROUND LEVEL.
- GABLE END WALLS TO BE SECURED AND ANCHORED WITH GALV. HOOP IRON STRAPS 1.2mm THICK BY 30mm WIDE AT 600 CENTRES EMBEDDED 600mm IN WALL, BENT OVER AND FIXED TO 3 RAFTERS.
- RAFTERS TO BE TIED DOWN TO WALLS WITH 1.2mm BY 30mm GALV. HOOP IRON STRAPS EMBEDDED 600mm IN WALL.
- ROOF TIMBERS TO BE 200MM MIN. FROM CHIMNEY FLUE
- PRE-CAST LINTOLS + 4 COURSES BRICKWORK WITH BRICKFORCE OVER ALL OPENINGS LESS THAN 3m WIDE.
- ALL STRUCTURAL TIMBER TO BE GRADE 4 S.A.P. AND WRAPPED IN D.P.M. WHEN BUILT IN WALLS.
- ALL NEW OR EXISTING DRAINAGE TO BE ENCASED IN CONCRETE UNDER NEW FLOOR SLABS.
- INTERNAL FOUNDATIONS = 700x230 STRIP CONCRETE
- NO PART OF ANY CONCRETE FOOTING TO ENCRANCH OVER ANY SITE BOUNDARY

FINISHES

- FLOORS**
 - QUARRY TILES IN ALL LIVING, BATHROOM AND SERVICE AREAS
 - CARPET IN BEDROOMS
 - QUARRY TILES TO ENCLOSED AND COVERED VERANDAH, SERVICE AND SERVANTS AREAS
 - CRUSHER RUN STONE CHIP TO YARD AREAS
- CEILING**
 - SKIMMED GYPSUM CEILING TO FIRST FLOOR AREAS WITH PROFILED GYPSUM CORNICE TO OWNERS CHOICE
 - SUSPENDED SKIMMED GYPSUM CEILING BELOW SLAB SOFFIT WITH PAINT FINISH AND PROFILED GYPSUM CORNICES (GROUND FLOOR AREAS)
- WALLS**
 - PLASTER AND PAINT FINISH TO SAMPLE APPROVAL BY ARCHITECT INTERNALLY AND EXTERNALLY
- PITCHED ROOFS**
 - "CHROMADEK" FACTORY APPLIED PAINT FINISH ON CORRUGATED GALVANISED SHEET METAL ON 50 x 75 SAP FURLINS ON TIMBER ROOF TRUSSES TO SPECIALIST DESIGN AND FABRICATION

N	WALL CHANGES AT ENTRANCE FOYER AREA	06 JULY 07
M	POOL AMENDMENTS	21 JUNE 07
L	AMENDMENTS	19 JUNE 07
K	DOOR AND WINDOW NUMBERS	30 MAY 07
J	CHANGES TO MAIDS ROOM	15 MAY 07
I	GENERAL CHANGES	03 MAY 07
H	GENERAL CHANGES	23 APRIL 07
G	1st FLOOR CEILING DROPPED, BALCONY REMOVED	17 APRIL 07
F	GENERAL CHANGES	22 MARCH 07
E	HOUSE REDUCED IN SIZE	5 MARCH 07
D	PANTRY REMOVED	1 MARCH 07
C	MAIN HOUSE REDUCED IN LENGTH BY 250MM	12 FEB. 07
B	GENERAL AMENDMENTS	8 FEB. 07
A	HOUSE DECREASED IN SIZE	30 JAN. 07
REV. No	REVISION	DATE

MICHAEL DALL

ARCHITECTS

27 MAINS AVENUE, KENILWORTH, CAPE TOWN, 7708
 TEL : (021) 797 8162 / 762 2383 FAX : (021) 797 7094
 mj.dall@iafrica.com

PROJECT TITLE

BISHOPSCOURT HOUSE

DRAWING TITLE

GROUND FLOOR PLAN

DRAWN	DATE	SCALE
SL	DECEMBER 2006	AS INDICATED
JOB NO.	DWG. NO.	REVISION
09 / 06	02	N

GROUND FLOOR PLAN
SCALE 1:100